

| EXISTING | LEGEND/PLAN | PROPOSED |
|------------|---------------------|------------|
| 150 W.M. | WATERMAIN | 150 W.M. |
| | HYDRANT | |
| | VALVE | |
| 300 LDS | LAND DRAINAGE SEWER | 300 LDS |
| 250 W.M.S. | WASTE WATER SEWER | 250 W.M.S. |
| | MANHOLE | |
| | CATCH BASIN | |
| | CURB INLET | |
| | JUNCTIONS | |
| | CULVERT | |
| | GAS | |
| | HYDRO | |
| | M.I.S. | |
| | CONCRETE | |
| | ASPHALT | |
| | SIDEWALK | |
| | PROPERTY LINE | |
| | SURVEY BAR | |

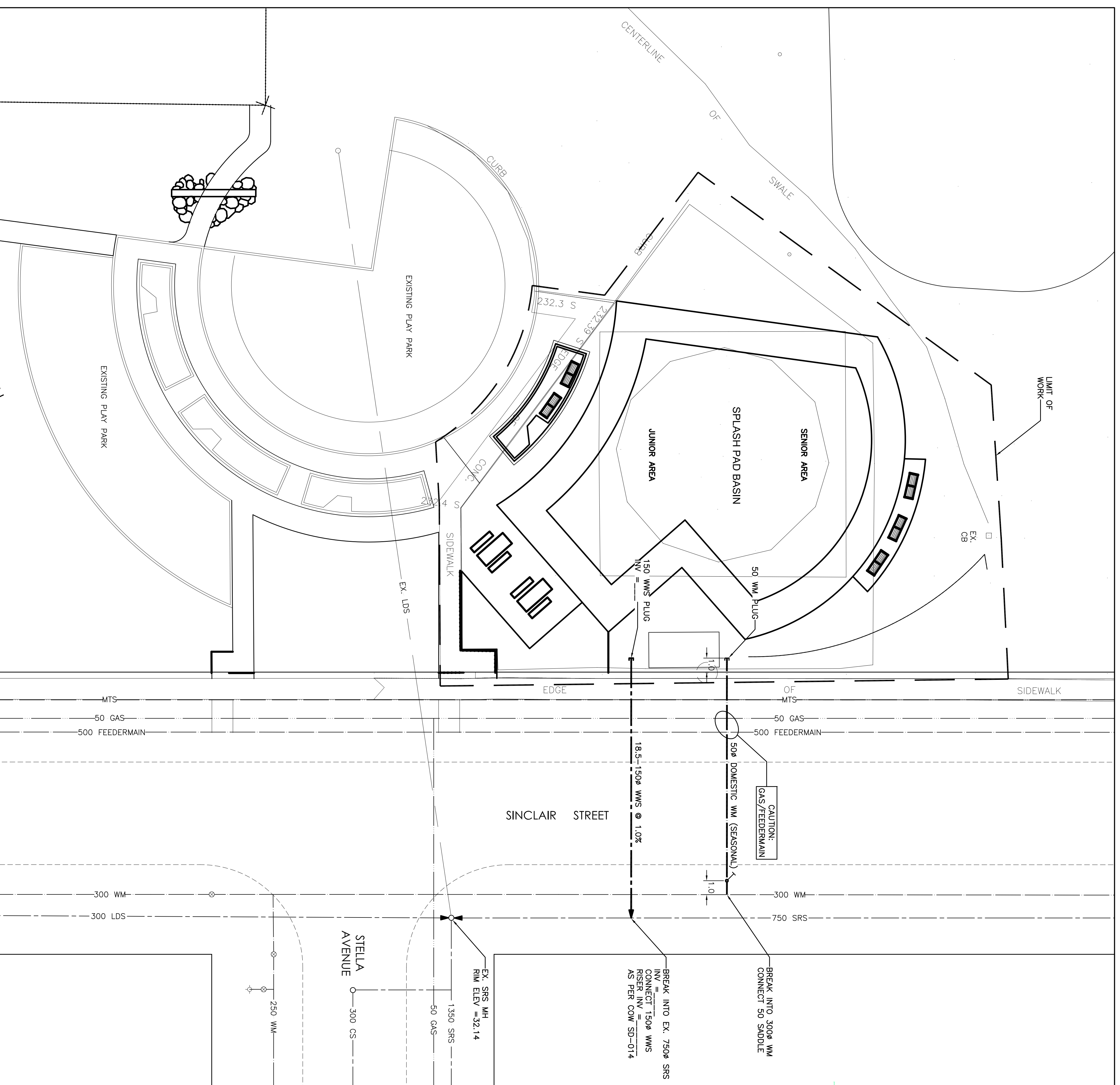

STORM WATER DISCHARGE CRITERIA

1. SITE RUNOFF RATE

| Surface | Area (ha) | C | CA | %IMP |
|-------------------|-----------|-------|-------|------|
| Non-contributing | 0.00 | 0.000 | 0% | 0% |
| Contributing Roof | 0.20 | 0.000 | 100% | 100% |
| Grass | 0.038 | 0.20 | 20% | 50% |
| Sealed Road | 0.90 | 0.000 | 100% | 100% |
| Paved | 0.083 | 0.95 | 0.075 | 100% |
| Catchment Total | 0.111 | 0.76 | 0.094 | 75% |

2. SITE RUNOFF PEAK

| Surface | Area (ha) | C | CA | %IMP |
|-------------------|-----------|-------|-------|------|
| Non-contributing | 0.00 | 0.000 | 0% | 0% |
| Contributing Roof | 0.20 | 0.000 | 100% | 100% |
| Grass | 0.20 | 0.000 | 50% | 20% |
| Sealed Road | 0.90 | 0.000 | 100% | 100% |
| Paved | 0.083 | 0.95 | 0.075 | 100% |
| Catchment Total | 0.111 | 0.86 | 0.075 | 61% |

Caution: 0.031 m/s

3. SANITARY FLOWS (BY OTHERS)

Overwinter = 0.001 m3/s

Oversummer = 0.001 m3/s

4. PEAK DISCHARGE PRECONSTRUCTION

Overwinter = 0.001 m3/s

Oversummer = 0.007 m3/s

5. PEAK DISCHARGE POSTCONSTRUCTION

Overwinter = 0.001 m3/s

Oversummer = 0.032 m3/s

GENERAL NOTES:

- CONTRACTOR TO VERIFY LOCATION, INVERTS AND TYPE OF ALL EXISTING BURIED UTILITIES PRIOR TO CONSTRUCTION AND NOTIFY ENGINEER OF ANY DISCREPANCIES.
- ALL MATERIALS AND CONSTRUCTION SHALL BE IN ACCORDANCE WITH THE LATEST EDITION OF THE CITY OF WINNIPEG STANDARD CONSTRUCTION SPECIFICATION.
- LDS PIPES TO BE PVC OR CONCRETE. WWS PIPE TO BE PVC SDP 35. MANHOLES TO BE BENCHED AS PER CITY OF WINNIPEG SD-010. ALL LDS PIPES 600 Ø AND LARGER TO BE CONCRETE C76-CLASS IV.
- WATERMAIN SERVICES TO BE PVC. CLASS 150, 50mm TO BE COPPER. ALL WATER SERVICES TO HAVE A MINIMUM OF 2.5 COVER. 50mm SERVICES TO BE INSTALLED AS PER CITY OF WINNIPEG SD-012.
- A MINIMUM PIPE SEPARATION OF 0.5m, MEASURED FROM OUTSIDE DIAMETER OF PIPES, SHALL BE PROVIDED BETWEEN ANY PROPOSED WORKS AND ANY OTHER PROPOSED WORKS. EXISTING WATER PIPE OR SEWER PIPE UNLESS OTHERWISE NOTED.
- CONTRACTOR TO CONFIRM THE LOCATION, DEPTH AND SIZES OF ALL SERVICE CONNECTIONS WITH BUILDING'S MECHANICAL/PLUMBING CONTRACTOR PRIOR TO SERVICE INSTALLATION.
- ALL TRENCH, MANHOLE AND CATCH BASIN BACKFILL FOR WATER SEWER AND PVC CONDUIT INSTALLATIONS SHALL BE CLASS B SAND BEDDING WITH CLASS 2 BACKFILL WHEN WITHIN 1.0m OR UNDER NEW OR PROPOSED PAVEMENT AREAS AND CLASS 4 BACKFILL IN LANDSCAPED AREAS.
- ALL WASTEWATER, LAND DRAINAGE AND WATER SERVICES SHALL TERMINATE AS SHOWN ON SERVICES PLAN.
- FOR LIGHT STANDARD BASES, ELECTRICAL CONDUITS AND WIRING, SEE ELECTRICAL DRAWINGS.
- FOR SUBDRAIN, TREES, SHRUBS, GRASS AND SEEDING DETAILS – SEE LANDSCAPE DRAWINGS. REFER TO LANDSCAPE FOR ALL CITY RIGHT-OF-WAY WORKS.
- THE CONTRACTOR SHALL CLEAN AND VIDEO INSPECT ALL LDS SEWERS PRIOR TO FINAL INSPECTION. THE CONTRACTOR SHALL SUBMIT (2) TWO COPIES OF THE WRITTEN REPORT AND VIDEO TO THE SITE SERVICING CONSULTANT.
- WATER VALVES AND BOXES TO BE INSTALLED AS PER CITY OF WINNIPEG STANDARD SD-008 AND SD-016. HYDRANT ASSEMBLIES SHALL CONFORM TO SD-006 UNLESS OTHERWISE INDICATED.
- ALL CATCH BASINS AND LDS MANHOLES TO HAVE STANDARD FRAME AP-004 AND 300mm DIA. COVERS AND 300mm WWS MANHOLES TO HAVE STANDARD FRAME AP-004 AND 250mm DIA. COVERS AND 250mm WWS MANHOLES TO HAVE STANDARD FRAME AP-004 AND 200mm DIA. COVERS AND 200mm WWS MANHOLES TO HAVE STANDARD FRAME AP-004 AND 150mm DIA. COVERS AND 150mm WWS MANHOLES TO HAVE STANDARD FRAME AP-004 AND 100mm DIA. COVERS AND 100mm WWS MANHOLES TO HAVE STANDARD FRAME AP-004 AND 75mm DIA. COVERS AND 75mm WWS MANHOLES TO HAVE STANDARD FRAME AP-004 AND 50mm DIA. COVERS AND 50mm WWS MANHOLES TO HAVE STANDARD FRAME AP-004 AND 25mm DIA. COVERS AND 25mm WWS MANHOLES TO HAVE STANDARD FRAME AP-004 AND 15mm DIA. COVERS AND 15mm WWS MANHOLES TO HAVE STANDARD FRAME AP-004 AND 10mm DIA. COVERS AND 10mm WWS MANHOLES TO HAVE STANDARD FRAME AP-004 AND 5mm DIA. COVERS AND 5mm WWS MANHOLES TO HAVE STANDARD FRAME AP-004 AND 2.5mm DIA. COVERS AND 2.5mm WWS MANHOLES TO HAVE STANDARD FRAME AP-004 AND 1.5mm DIA. COVERS AND 1.5mm WWS MANHOLES TO HAVE STANDARD FRAME AP-004 AND 1.0mm DIA. COVERS AND 1.0mm WWS MANHOLES TO HAVE STANDARD FRAME AP-004 AND 0.5mm DIA. COVERS AND 0.5mm WWS MANHOLES TO HAVE STANDARD FRAME AP-004 AND 0.25mm DIA. COVERS AND 0.25mm WWS MANHOLES TO HAVE STANDARD FRAME AP-004 AND 0.15m IN HEIGHT UNLESS OTHERWISE NOTED.
- ALL CATCH BASINS TO HAVE 250MM DIA. LEADS UNLESS OTHERWISE NOTED.
- ALL CONCRETE CURBS TO BE 0.15m IN HEIGHT UNLESS OTHERWISE NOTED.

WARNING

IF POWER EQUIPMENT OR EMPLOYEES ARE TO BE USED MUST BE CALLED ON THIS PROJECT THE CONTRACTOR 1) NOTIFY THE GAS COMPANY OF THE PROPOSED LOCATION OF EXCAVATION TO AVOID DAMAGE TO GAS COMPANY INSTALLATIONS. 2) NOTIFY THE GAS COMPANY TO AVOID DAMAGE TO GAS COMPANY INSTALLATIONS. 3) NOTIFY THE GAS COMPANY OF THE PROPOSED LOCATION OF EXCAVATION TO AVOID DAMAGE TO GAS COMPANY INSTALLATIONS. SEE PROVINCIAL REGULATION 140/92 FOR DETAILS.

METRIC

WHOLE NUMBERS INDICATE MILLIMETRES
DECIMALIZED NUMBERS INDICATE METRES

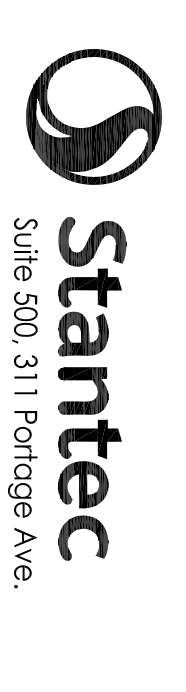

| No. | Revisions | Date | By |
|---------------------------|--------------------|------------|-----|
| 1 | ISSUED FOR Bidding | 2017-07-14 | ink |
| Scale: As Shown | | | |
| Date: 14-07-2017 11:15:00 | | | |

| | | | |
|-------------|----|------------|----|
| Designed By | DK | Checked By | NK |
| Drawn By | KR | | |
| CD | | | |

Client
CITY OF WINNIPEG

Project Title
NORTH END RECREATION CENTER SPRAY PAD

Sheet Title
SITE SERVICING PLAN

Certificate of Authorization
Stamtec Consulting Ltd.
No. 1301

Project No.
571-2017

Drawing No.
C-101



SITE SERVICING PLAN
SCALE: 1:150